

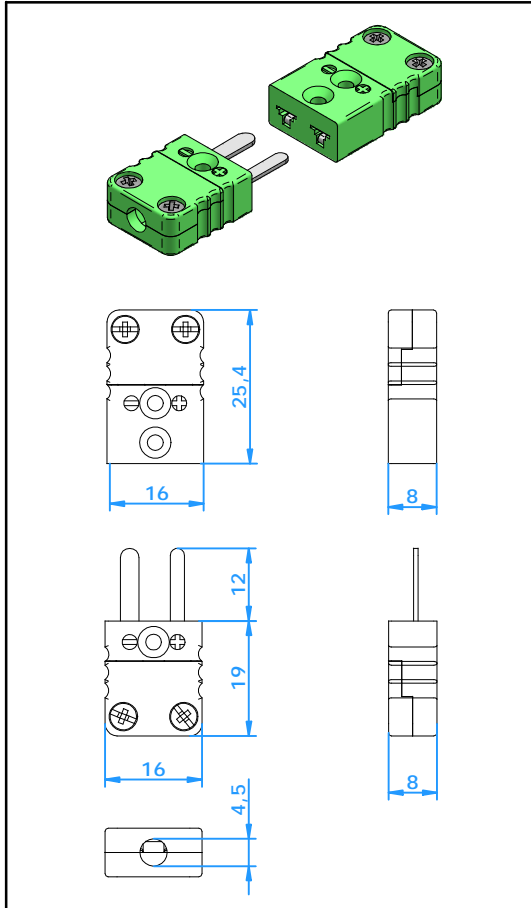

Connectors

Miniature Connector Economy



Application

Connector for thermocouple circuits. Suited for small wires and mineral insulated cables. Especially designed for cost sensitive applications.

Construction

- Glass filled Nylon body with original thermocouple material pins and springloaded inserts.
- Polarized pins ensure proper connection.
- Molded barriers prevent short circuit.
- Rugged one body design.
- Zinc plated steel screws with slotted head

Wire size

- Accepts wires from 0,002 mm to 0,6 mm.
- Maximum cable diameter 4,5 mm.

Temperature rating

- 200 °C Max.

Color Code

- Available according to ANSI and IEC, see table below

Accessories

- See separate specification sheet.

Ordering Code Plug: CMPE-xx
Jack: CMJE-xx

For last two digits 'xx' see table below

Calibration Code	J	K	N	T	R/S
Compensation Material for Contact Material Positive	Fe	NiCr	NiCrSi	Cu	Pt13Rh/Pt
Contact Material Negative	CuNi	NiAl	NiSi	CuNi	Cu Alloy #11
IEC Color Code					
Color Body	Black	Green	Pink	Brown	Orange
Code	J1	K1	N1	T1	R1
ANSI Color Code					
Color Body	Black	Yellow	Pink	Blue	Green
Code	J1	KA	NA	TA	RA